

Page 560

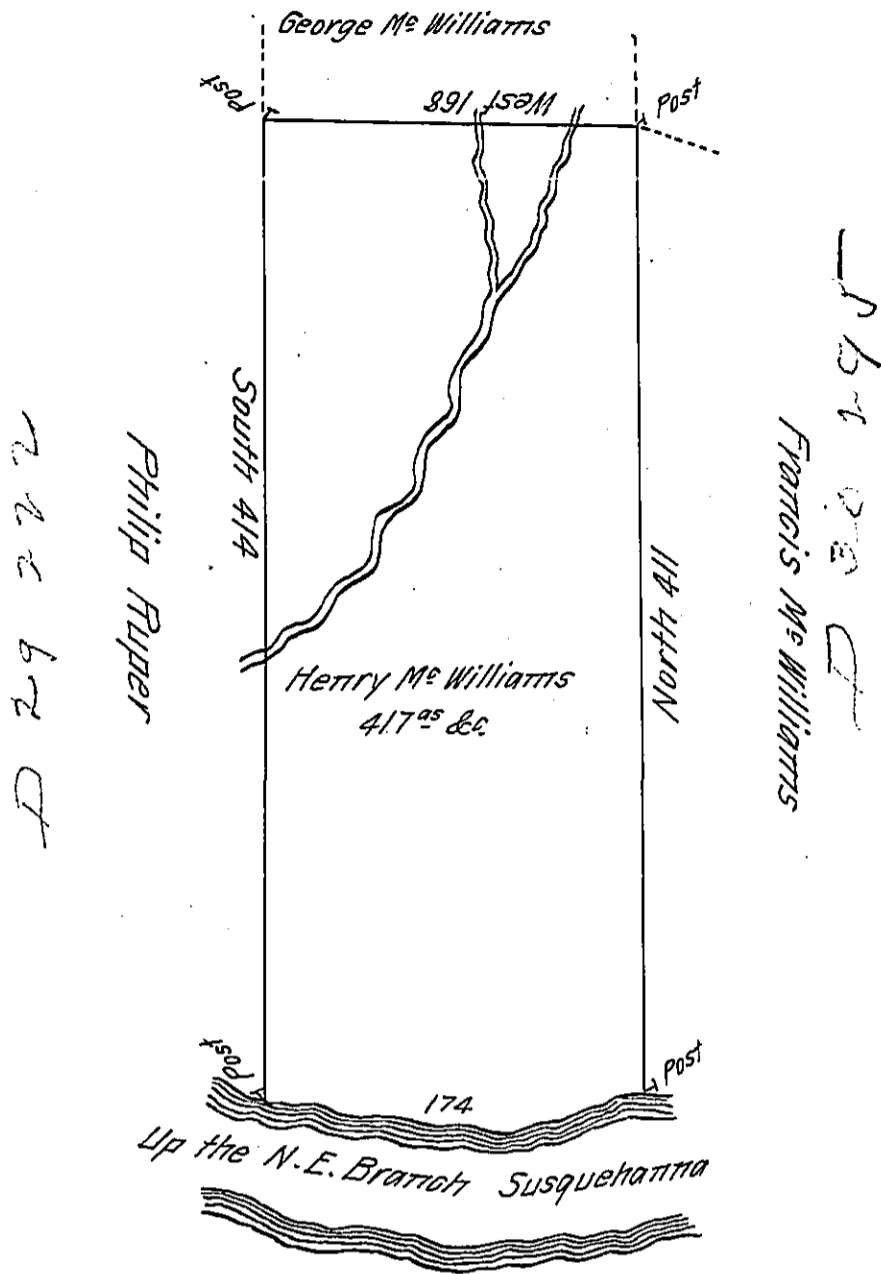

A Draught of a tract of land Called — Situate in the Great Bend on the
 N. E. Branch of Susqu^a. Joining land Surveyed for Geo. Mc Williams in Northumberland
 County Containing four Hundred & Seventeen Acres & Allowance of Six P. Cent for
 roads &c Surveyed for Henry Mc Williams the 2^d Day of June 1785 in Pursuance of
 a Warrant Dated the 4th Day of April 1785.

by W^m Gray D. S.

To John Lukens Esq^r }
 Surv^r. Gen^l. }

IN TESTIMONY that the above is a copy of the original remaining on file in
 the Department of Internal Affairs of Pennsylvania, made
 conformably to an Act of Assembly approved the 16th day of
 February, 1833, I have hereunto set my Hand and caused
 the Seal of said Department to be affixed at Harrisburg,
 this teenth day of January 1912

Henry Honck
 Secretary of Internal Affairs.